

JBC

www.jbctools.com

English



Thermometer

Ref. TIA-A

Packing List

The following items should be included:

Thermometer 1 unit



Cable 1 unit



Manual 1 unit



Operation

For a correct temperature reading, you need to apply solder to the center of the sensor wire.

1. Apply solder

The soldering tip must be properly tinned before taking a reading.

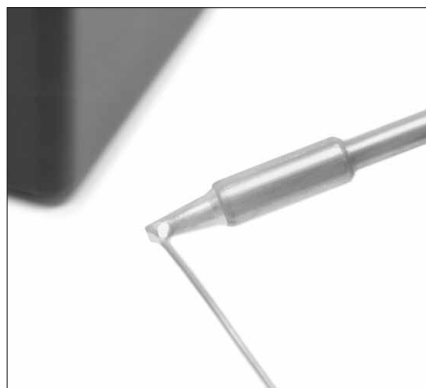

2. Read the temperature

Place the tip in the centre of the sensor. This is reinforced for this purpose. Wait until the temperature stabilizes.



Reading the Sleep temperature

Connect one end of the cable to the metal part of the tool stand and the other end to the cartridge and proceed according to the instructions in Operation (steps 1 & 2).

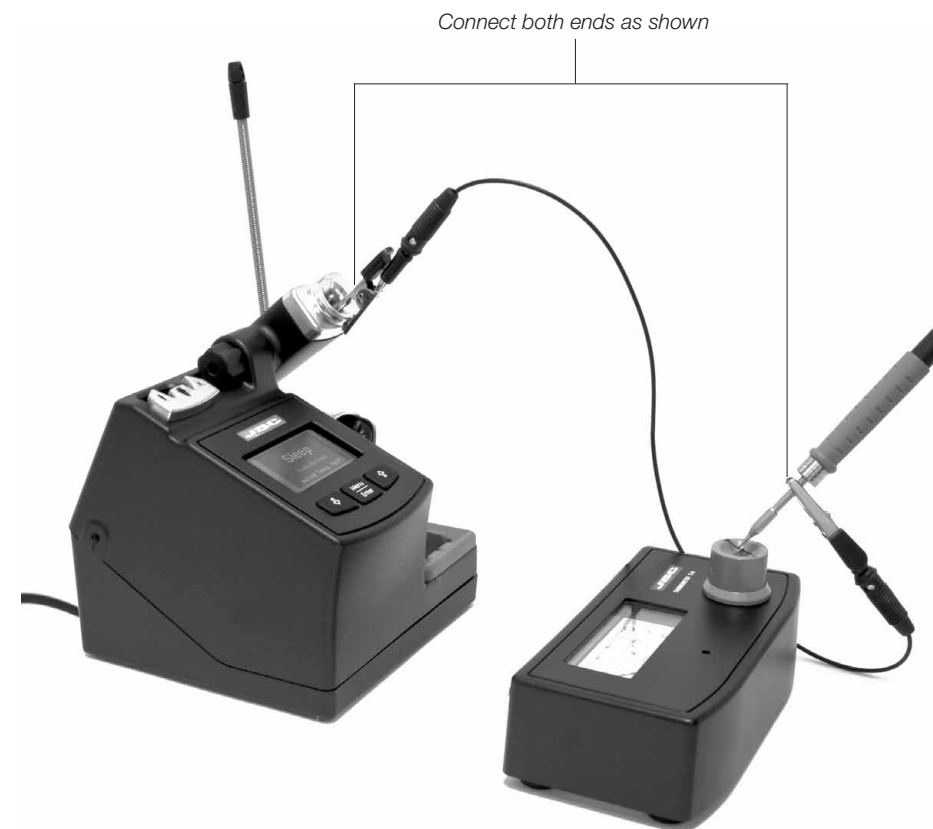

Calibration

1. Pull out the sensor and adjust the reading needle using a screwdriver at room temperature.

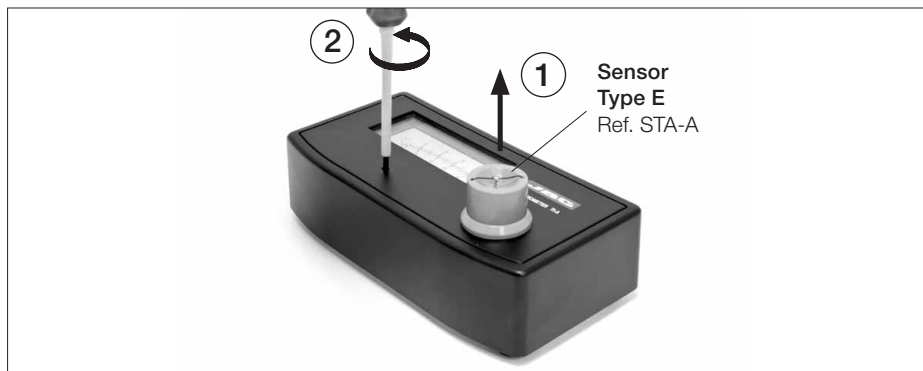

2. Connect the TIA-A Thermometer as follows:

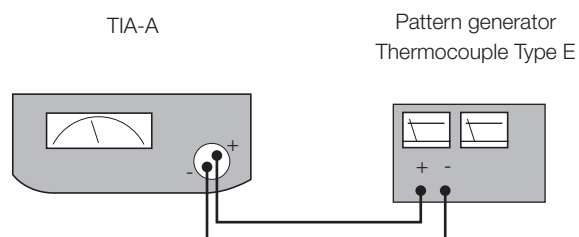

3. Choose the temperature on the generator and take a reading on the thermometer.

4. Take note of the deviation to correct future readings.

5. Fit the STA-A sensor in place.

Changing the sensor

To replace the STA-A sensor pull it off the base.

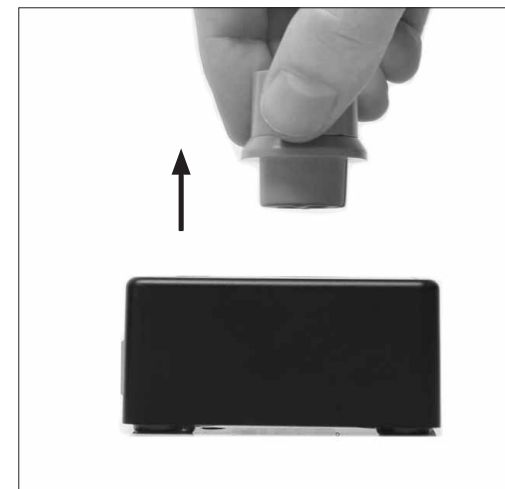

Specifications

- Temperature range: 20-500°C (69-920°F)
- Thermocouple: Type E
- Ambient temperature correction: Adjusted for 20°C (68°F)
- Scale Unit: 10°C (20°F)
- Total weight of unit: 0.7 Kg

Complies with CE standards.
ESD protected housing "skin effect".

JBC

Warranty

JBC's 2 year warranty covers this equipment against all manufacturing defects, including the replacement of defective parts and labour. Warranty does not cover product wear due to use or mis-use.

In order for the warranty to be valid, equipment must be returned, postage paid, to the dealer where it was purchased.



This product should not be thrown in the garbage. In accordance with the European directive 2002/96/EC, electronic equipment at the end of their life must be collected and returned to an authorized recycling facility.