

F1204

FUME EXTRACTOR
ACCESSORY AP

Reference Guide

F1204/ FUME EXTRACTOR ACCESSORY AP

CONTENTS

0555326

SUCTION HOSE



0451205

METAL
SUCTION TUBE



0056370

SILICON TUBE



0965582 X 4

BRIDLE

S

MANUAL



INSTALLATION

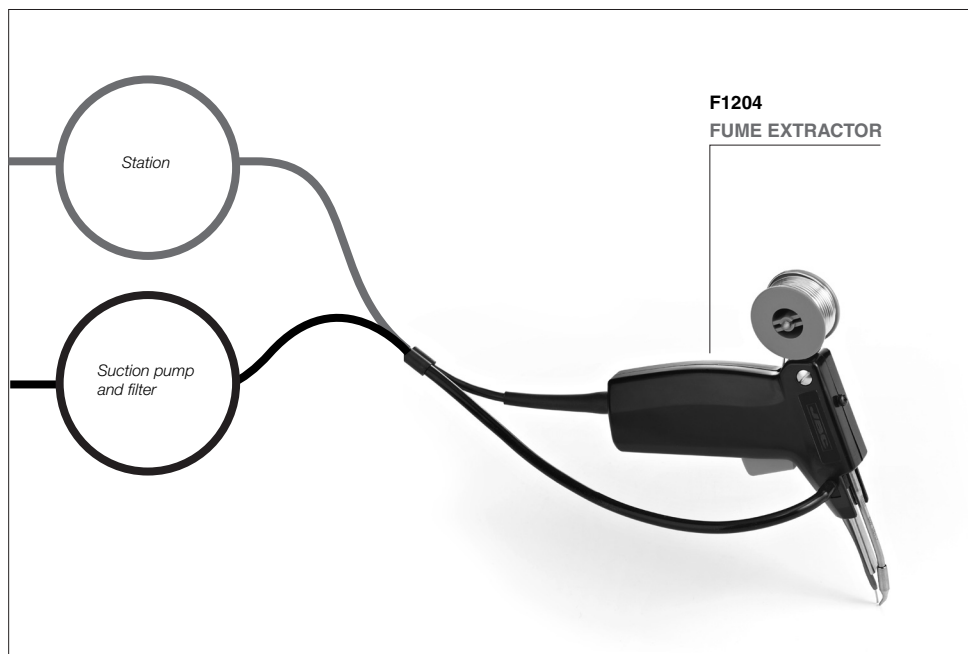

INSTALLATION

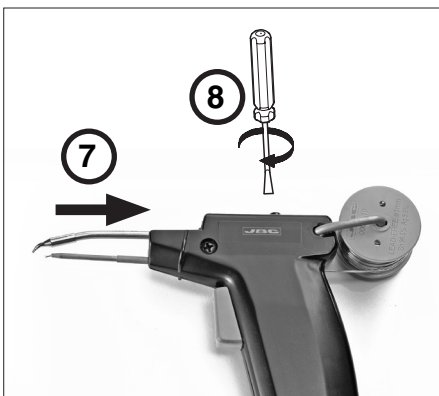
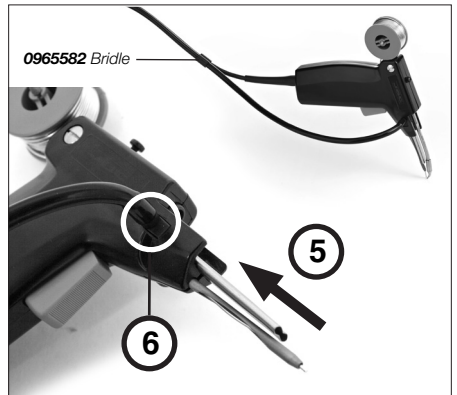
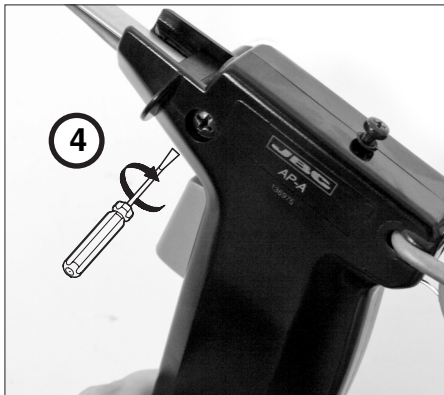
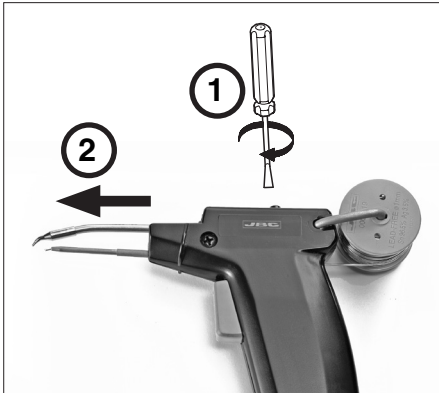

Please make sure that the soldering iron is not connected to the station. This step has to be performed when the cartridge is cold.

1-2 Loosen the cartridge screw. Take out the cartridge to allow the tube to enter.

3 Place the suction hose in the soldering housing.

4-5-6 Loosen the screw (4). Position the metal suction tube and press it into place. Strap the silicone tube to the soldering iron cable using the bridles to make it more manageable. Tighten the screw (4).

7-8 Insert the cartridge. Tighten the screw.



This product should not be thrown in the garbage.



WARRANTY

The JBC 2 years warranty, guarantees this equipment against all manufacturing defects, covering the replacement of defective parts and all necessary labour.

Warranty does not cover product wear due to use or mis-use.

In order for the warranty to be valid, equipment must be returned, postage paid, to the dealer where it was purchased enclosing this, fully filled in, sheet.

SERIAL N°

STAMP OF DEALER

DATE OF PURCHASE

MORE INFORMATION
www.jbctools.com